

**City of Anderson
Development Services Division**

1887 Howard Street
Anderson CA, 96007
Telephone (530) 378-6636
www.ci.anderson.ca.us

Kitchen Remodel

Information
Bulletin
BP-07

Eff. 06-08-2018

Purpose

This checklist applies to kitchen remodeling projects for single-family dwellings and is to be used as a general reference guide.

What do I need to bring to obtain a kitchen remodel permit?

To apply for a permit please bring in three sets of plans (minimum 11"x17") showing the existing and the new kitchen layout with all new electrical, plumbing and mechanical system changes. Please include engineered plans and calculations if any structural modifications will be made to the building.

The plans and the permit application should have a detailed description identifying the scope of work so the contractor and Building Department know what you intend to do and to eliminate any delays in the permit issuance and inspection process. Once a permit has been issued it will be limited to the scope of work identified on the plans and in the permit application only – see sample floor plan on next page.

Electrical Requirements (2016 CEC)

- Two 20-amp small-appliance circuits; can only serve outlets – for the required kitchen countertop and wall outlets including refrigeration equipment [210-11(C)(1), 210-52(B)(1)& (B)(2)]
- Provide separate and dedicated circuits with I.D. for garbage disposal, dishwasher, built-in microwave, trash compactor, and refrigeration equipment [210-52 (B)]
- Garbage disposal & dishwasher can use a listed flexible cord of 18" to 36" of G.D. and 36" to 48" for Dishwasher. Receptacles must be accessible and not behind appliance [422-16(B)(1) & (2)]

- GFCI protection at the following locations:..... [210-8(A)(6) & (7)]
 - a. All receptacles serving kitchen countertops
 - b. All receptacles within 6' of other sinks
- Provide additional receptacle outlets for countertop as follows:
 - a. In each wall space or countertop wider than 12"
 - b. Spaced so that no point along the wall and counter space line is more than 24" from a receptacle
 - c. Installed at each countertop island and peninsular countertop meeting minimum dimensions [210-52(C)(1)(2)(3)(4) (5)]
- Receptacle for refrigeration equipment may be attached to the small appliance circuit [210-52(B)(1) ex.2]

Plumbing Requirements (2016 CPC)

- Dishwasher air gap required above sink flood rim [807.3]
- Special venting for island fixtures [909]

Mechanical Requirements (2016 CMC)

- Provide installation instructions for all listed equipment to field inspector at time of inspection [303.0]
- Environmental air ducts shall terminate not less than 3' from property lines, 10 feet from forced air inlets, and 3 feet from openings into the building. [502.2.1]

Residential Lighting Requirements (2016 Energy Standards)

- All installed luminaires shall be high-efficacy in accordance with Section 150.0(k) and Table 150.0-A of the 2016 California Energy Code.

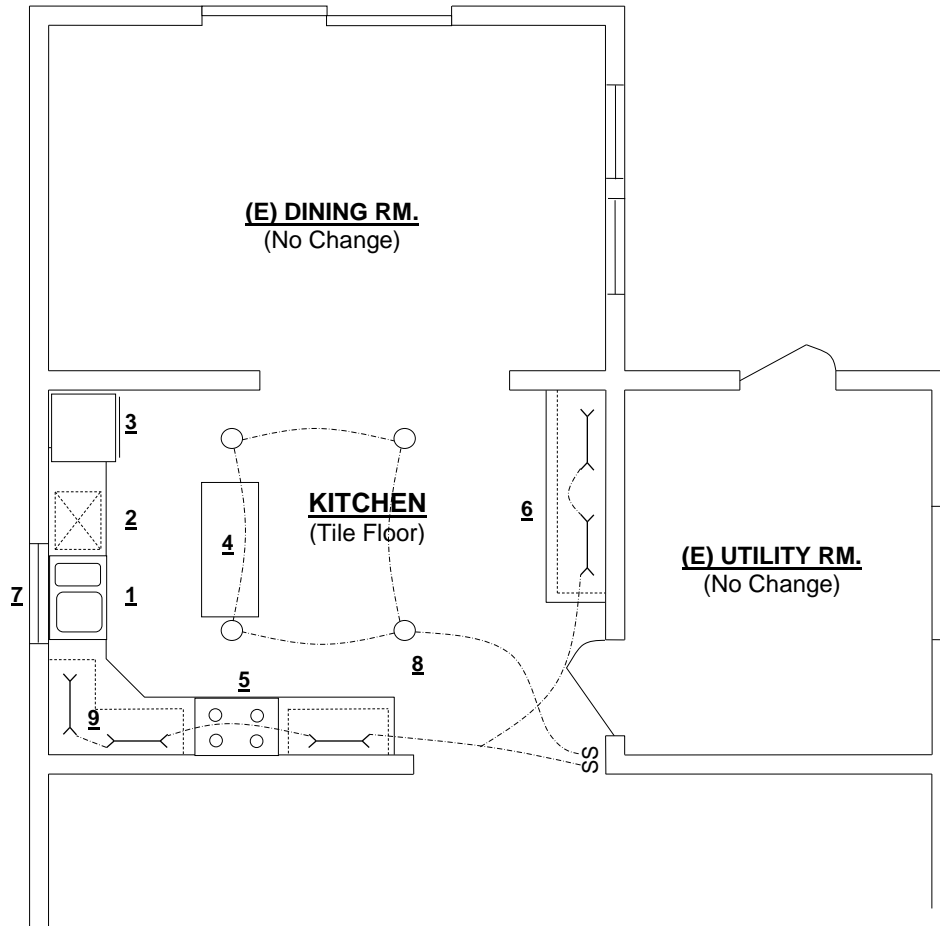

SCOPE OF WORK:

Kitchen layout will remain the same. Work includes removal and replacement of kitchen appliances (dishwasher, sink, oven, range, countertops and cabinets, flooring, and light fixtures).

FLOOR PLAN KEYNOTES:

1. Double sink
2. Dishwasher with required airgap
3. Refrigerator
4. Island cabinet
5. Cooktop with hood
6. Countertops & cabinets above
7. (E) Window – no change
8. (N) High efficiency down lights
9. (N) High efficiency under counter lights.

If the layout of the cabinets change, the electrical receptacle requirements may change with the new cabinets.

SAMPLE FLOOR PLAN
PROPOSED KITCHEN REMODEL
(NOT TO SCALE)

100 Pleasant Circle
Anderson, CA 96007

Mr. & Mrs. Right
Ph: (530) 378-6636